



---

# PANTHER EASY RIDER

---



818-806-9386



info@treefortent.com



@treefortentertainment

# PANTHER EASY RIDER



Treefort's Panther Easy Rider is an E-Trike / Cine Trike that is perfect for dynamic camera moves. The standard version of the Easy Rider is a manually operated rickshaw dolly. An additionally available Drive Unit turns it into a E-Trike vehicle, which is powered by a silent electric motor, allowing it to reach speeds up to 19 mph.

# PANTHER EASY RIDER

Length	Width	Max Speed	Max Range (est.)	Max Payload Capacity
6'-1"	2'-4"	19 mph	19 mi	882 lbs





# EASY RIDER

---

USER MANUAL



# TABLE OF CONTENTS

TOPIC	PAGE
Safety Instructions	5
Technical Data	6
Basic Knowledge	7
Overview	7
Allen Key	9
Rickshaw Mode	10
Height Adjustment	10
Suspension Adjustment	12
Sledge	15
Seat	16
Foot Rest	17
Support Wheel	18
Counter Weight	19
Clamps	20
Bracket 48-80mm	22
E-Drive Mode	23
Setup	23
Battery	25
Steering Bar	26
Drive	27
Safety Support Wheels	28

# TABLE OF CONTENTS

TOPIC	PAGE
Counter Weight	29
Seat Bracket	30
Foot Rest	30
Fender	31
Track Mode	32
Transport	33
Notes	34

# SAFETY INSTRUCTIONS

## Before Driving

Make sure that the wheel pressure of all wheels always is between 2,5 and 3 bar.

Do never drive on public roads.

Every load must be checked and secured prior usage - pay particular attention to the stability against tipping. All parts must be secured against falling. The center of gravity of the load should always be as low as possible.

Do not switch on the Easy Rider before the operator/driver is ready in order to avoid unintentionally movements by pressing the thumb lever.

Check that the brakes are working properly before every operation with the Easy Rider.

Check all screws regularly.



Check after each use these 4 screws and tighten them with a torque of 25Nm!

## While Driving

Be ready to brake at all times.

Avoid sudden steering maneuvers and dynamic curving to prevent tipping over.

Always switch off the Easy Rider after driving.

# TECHNICAL DATA

## Rickshaw Mode (Sideview / Topview)



Length (Dolly)	78 cm / 30,7"
Width (Dolly)	61 cm / 24" (w/o suspension)   70 cm / 27,6" (with suspension)
max. Payload	250 kg / 551 lbs

## E-Drive Mode (Sideview / Topview)



Length (Dolly)	185 cm / 72,8"
Width (Dolly)	61 cm / 24" (w/o suspension)   70 cm / 27,6" (with suspension)
max. Payload	400 kg / 882 lbs
Top Speed	30 km/h / 19 mph
max. Range (est.)	30 km / 19 mi



# BASIC KNOWLEDGE

## ALLEN KEY

### Integrated Allen Key

We designed the Easy Rider to be used almost tool-free in order to ensure a fast and easy operating. If there is a tool needed it is always the same: only one Allen Key which has its parking position directly on side of the dolly. This gives you, the operator, the possibility to work fast and easy, without losing time for searching the right tool.



# RICKSHAW MODE

## HEIGHT ADJUSTMENT

### Rickshaw without suspension

There are 3 different height positions possible.



Adjusting height is done by opening the screw.



Take off the wheel and bring it back to the desired position.

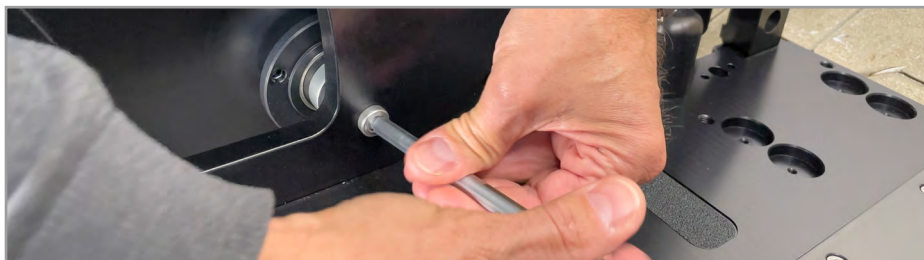

Then tighten the screw.

# RICKSHAW MODE

## HEIGHT ADJUSTMENT

### Rickshaw with suspension

There are 3 different height positions possible.



Open the screw and reposition the Rickshaw height. Support the platform to prevent falling down when changing height position.



Then tighten the screw.



Sometimes it might be useful to adjust the height differently to compensate unevenness.

# RICKSHAW MODE

## SUSPENSION ADJUSTMENT

### Suspension adjustment



First make sure you open the locking screw.



Turn the golden knob of dampening all the way to „-“ (minus)



To adjust the suspension correctly you have to make sure that the suspension travel (Easy Rider loaded) is balanced. Recognizable on the dampener (see picture right).

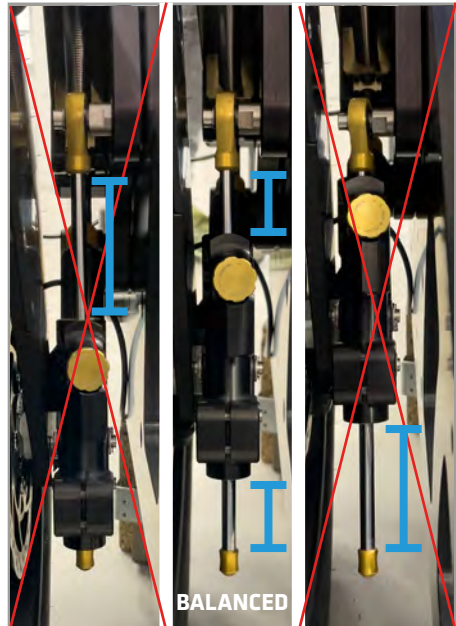

# RICKSHAW MODE

## SUSPENSION ADJUSTMENT



Lock the adjusted suspension.



Adjust dampening to your needs by turning to „+“ (plus)

# RICKSHAW MODE

## SUSPENSION ADJUSTMENT

### Suspension adjustment

There is an option to remove the roll bar if you want to have each wheel dampened individually.



To remove the roll bar open the two marked screws and take out the bar.



# RICKSHAW MODE

## ACCESSORIES

### Sledge

The sledge can be used to mount accessories with 80mm Tube Mount / Euro Mount.

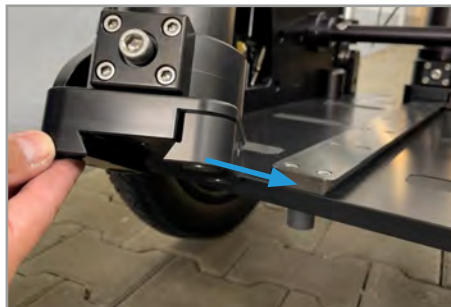

Push the sledge onto the dove tail bar.

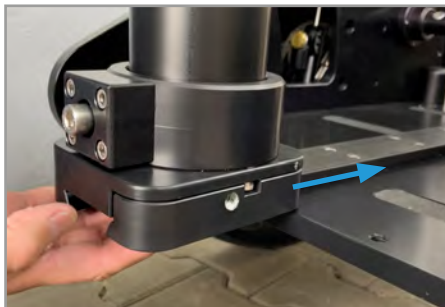

Slide it into the desired position.



1. for locking 80mm Tubes / Euromounts
2. for locking the position

# RICKSHAW MODE

## ACCESSORIES

### Seat



Push the seat into the Seat Column.



Tighten the screw.



You can use every 25mm Pin Seat.



Adjusting height is done by opening the lever.  
Be careful with the spring loaded seat!



If needed you can use the 80mm tube separately. To do so, remove the tube by opening the screw. Pay attention to turn the screw correctly:

Turning **clockwise**: you contract the tube connector which means you **loosen** the tube.

Turning **counter clockwise**: you spread the tube connector which means you **lock** the tube.





# RICKSHAW MODE

## ACCESSORIES

### Foot Rest

There are Foot Rests and extensions available.



Mounting the Foot Rest is done by tighten the screw.



You can change the left/right position by opening the screw.



If you need more length you can mount extensions the same way. You can combine up to **two** extensions.



Finally mount the foot rest.

# RICKSHAW MODE

## ACCESSORIES

### Support Wheel

Additional Support for the Rickshaw Mode.



To mount the Support Wheel you need a sledge. Mount the 80mm tube into it.



Adjusting height is done by opening the black lever and repositioning height.

# RICKSHAW MODE

## ACCESSORIES

### Clamps

We offer black anodized 48mm scaffold tubes which can be combined with clamps (312610).



The Clamp is mounted with one screw that is mounted on the side plate.



Scaffold tubes can be mounted tool free.



With the Clamp rotating  $\varnothing$  33mm - 48 mm (180075) you can mount in any direction.

# RICKSHAW MODE

## ACCESSORIES

### Clamps

The clamps can be also used to extend the push bar for 1 or 2 operators with scaffold tubes.



The clamp can be mounted with the integrated Allen Key.



Place washer between pushbar and clamp.



Mount scaffold tubes up to 2m length.

# RICKSHAW MODE

## ACCESSORIES

### Bracket 48-80mm



The Bracket 48-80mm can be mounted to every 80mm tube.

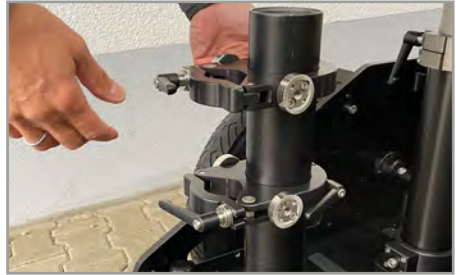

We recommend to use 2 for save operating.



To mount a 48mm tube (scaffold tube) open the black lever.



It is also possible to attach foot rests directly to the Bracket 48-80mm.

# E-DRIVE MODE SETUP

## Drive Unit

You can transform the Rickshaw Mode into the E-Drive Mode with the Drive Unit (311809).

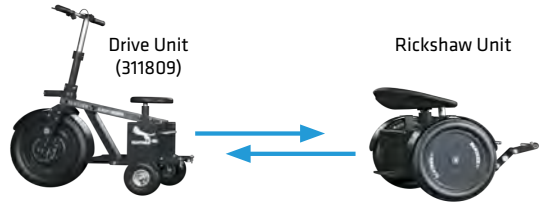

Rickshaw Unit must be height adjusted on „high level“ first (see page 11) to facilitate connection.



Hold the Rickshaw at an angle and move it to the Drive Unit until the magnets „click in“.



Both elements are now in position.



(Topview) Tighten all 4 screws.



# E-DRIVE MODE SETUP

## Drive Unit



Remove the Grip from the Push Bar.



Mount it to the front steering bar.



Make sure to tighten the screw.



Attach the brake hose onto the Easy Rider with straps for safety.



Open the knob of the assembly wheels.



Make sure to bring the Assembly Wheels up before operating!

# E-DRIVE MODE SETUP



Switch Off Dolly before charging batteries. Otherwise battery connector may be burned (shortcut).

## Battery

The Easy Rider is powered by 4 Panther batteries (302577).



Open the lid for the batteries.



Insert the batteries and make sure that it locks.

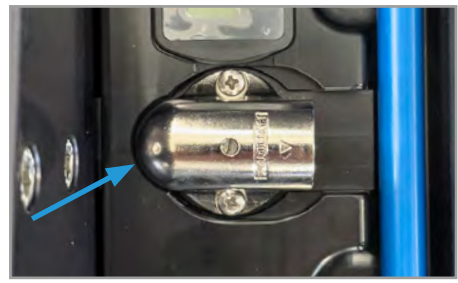
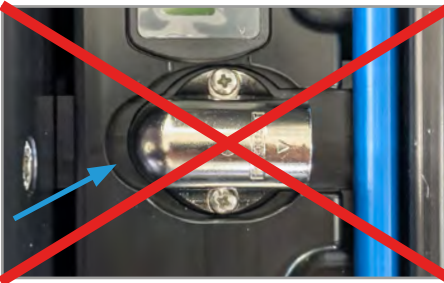

Make sure, batteries are completely pushed into its place and are safely locked.

The battery is empty if the display shows 50% or less. Status display is just an indicator and may not be precise. Check voltage of Batteries with a voltmeter.  
25,5V-26V is full - 22,5V or less is empty.



# E-DRIVE MODE SETUP

## Steering bar

Adjust height



Before operating make sure that the steering bar is adjusted to your body size.



Use the integrated allen key to adjust the height.

# E-DRIVE MODE

## DRIVE

### Drive



Turn on the Easy Rider by pressing both switches up. **Always switch both!**



The yellow control light shows you that your Easy Rider is turned on.



By pressing the thumb lever the Easy Rider begins to drive forwards.

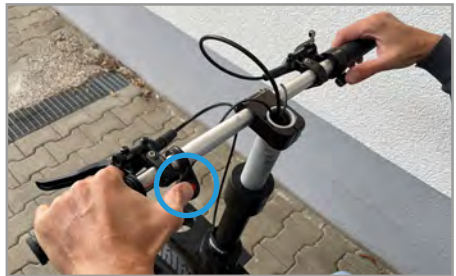

If you press the red button on the left simultaneously it will drive backwards.



Do not switch on the Easy Rider before the operator/driver is ready in order to avoid unintentionally movements by pressing the thumb lever.

Always make sure to turn off the Easy Rider when you are not operating to increase the battery life.

Shattering noise of the motor (front wheel) indicates that the battery has not enough voltage anymore. Please change or charge batteries.

# E-DRIVE MODE

## ACCESSORIES

### Seat Bracket

Remember: the lower the weight of the seat, the more stability you have.



Mounting „overslung“.



Mounting „underslung“.



You are able to mount foot rests and extensions directly onto it.



Now you can mount the seat to the front.

### Foot Rest



To maximise driving stability you can mount foot rests directly to the front wheel.



# E-DRIVE MODE

## ACCESSORIES

### Fender



Fender backside (Rickshaw)



Slide the fenders onto the axis.



Make sure it holds by itself

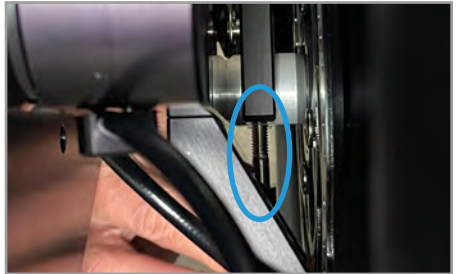

Tighten the screw.

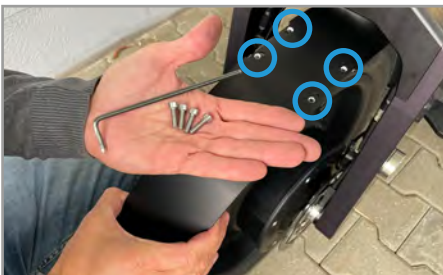

The fender for the front is mounted with 4 screws.



Tighten the screws.

## ■ TRANSPORT

The Easy Rider might be delivered in a backpack setup. To detach open the screw and remove the Rickshaw Unit.

This backpack setup may be useful for compact storage.

